

# Sensory Map

Key:

- Area of possible high level noise ■
- Area of lower level noise ■

1. Museum Admissions and PK Shop
2. Cafe PK
3. Main Exhibition
4. Demonstration Area

## Museum- entry level

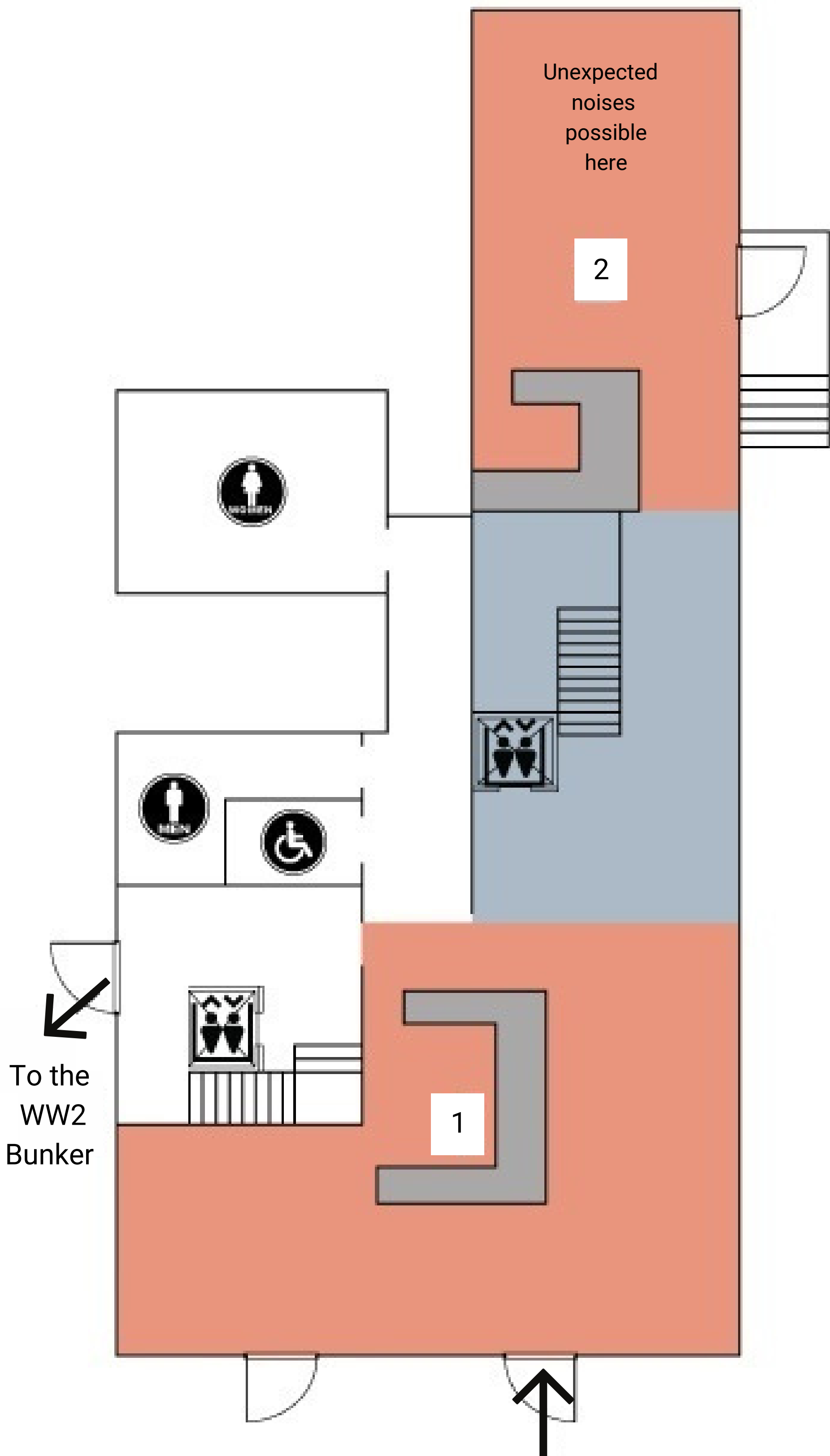

## Museum first floor

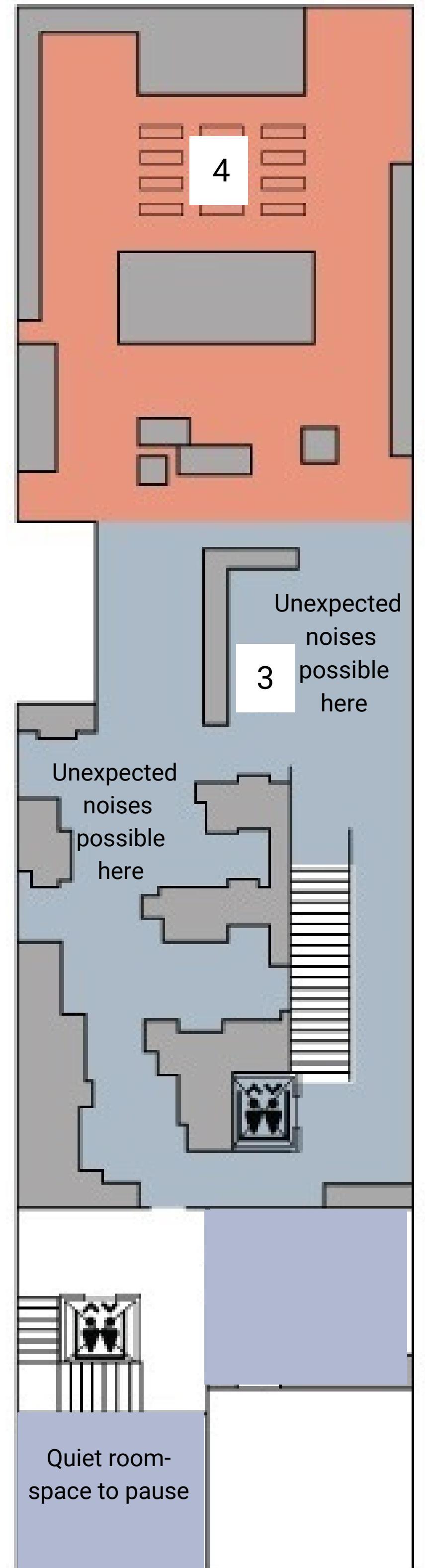

Main entrance to museum

Key:

Areas of possible high level noise



Areas of lower level noise



- 1. World War II exhibitions
- 2. Escape stairs to viewing platform
- 3. Fibre Optic exhibition
- 4. Testing room

- 5. Gallery 1 (temporary exhibition space)
- 6. Gallery 2 (temporary exhibition space)
- 7. Radio hut

### The Wilshaw Building

### WW2 Bunker

